

GROUNDWORKERS

External threshold solutions

Simple insulation solution for below ground level cold bridging at door thresholds

Alreflex Full Fill

Threshold Boards provide a simple and highly effective solution for reducing thermal bridging at door thresholds. The boards are supplied in sizes to suit door widths, so no cutting is required and wastage is eliminated.

To discuss your requirements or for project specific Psi value calculations please contact our Technical Department on 01582 544255.

Suitable for all door types

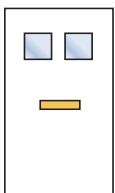

Front

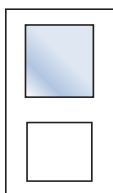

Rear

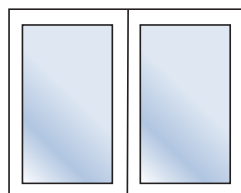

Patio/French

Alreflex Full Fill Threshold Boards:

- Reduces Cold Bridging
- Bespoke sizes, eliminating wastage
- Suitable for Insitu Slabs and Beam & Block floors
- Specified by a number of the largest house builders in the UK
- Utilises Alreflex Full Fill, a BBA certified cavity wall insulation
- Suitable for Front Doors, Rear Doors and French Doors

Please note:

The constructions shown in these details are examples.

Alreflex Full Fill Threshold Boards can be used in most threshold situations.



Installation- Insitu Concrete

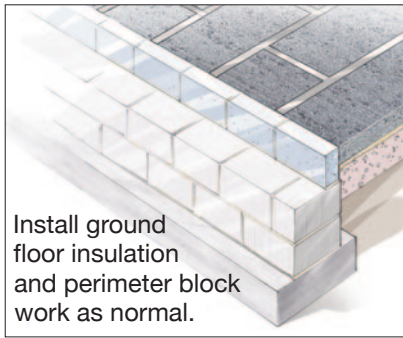

Install ground floor insulation and perimeter block work as normal.

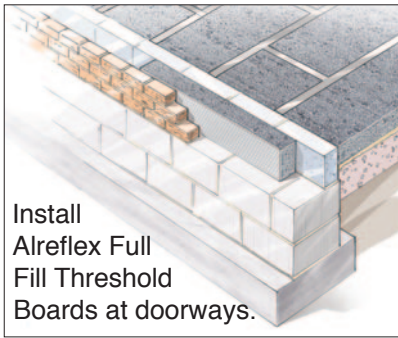

Install Alreflex Full Fill Threshold Boards at doorways.

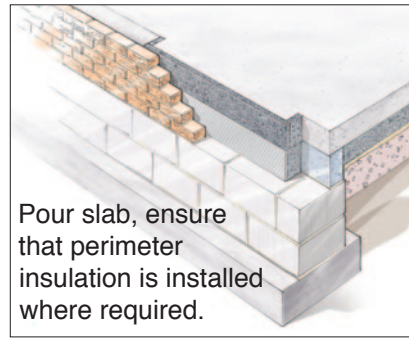

Pour slab, ensure that perimeter insulation is installed where required.

Installation- Beam & Block

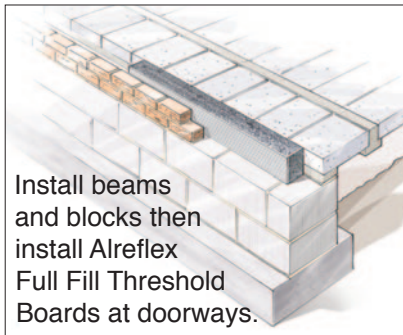

Install beams and blocks then install Alreflex Full Fill Threshold Boards at doorways.

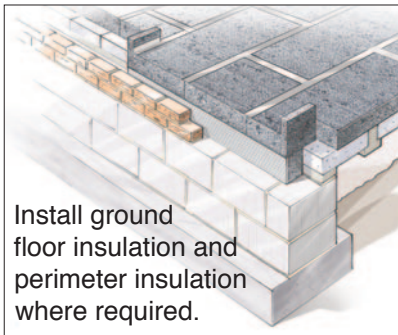

Install ground floor insulation and perimeter insulation where required.

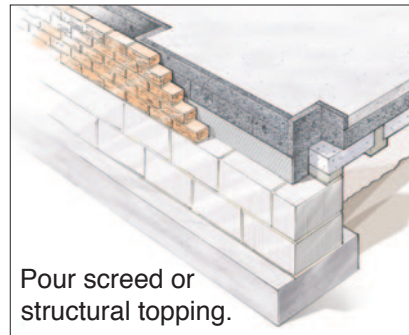

Pour screed or structural topping.

Thermal Economics provide a full range of thermal products to offer complete project solutions.



TE Platinum
Ground Floor
Insulation



Alreflex
Platinum
Cavity Wall



Alreflex
FullFill

For more information on Thermal Economics products please visit our website or call us on 01582 450814.

ENVIRONMENTALLY FRIENDLY MATERIALS - RECYCLED & SUSTAINABLY SOURCED

Thermal Economics is an ISO 9001 and ISO 14001 certified company with a proven history of developing high performance innovative products using recycled and sustainable materials.

As the core of our Thermal Insulation we utilise **100% recyclable** EPS. Not only is EPS an excellent insulator, but also one



of the few materials given an **A+** environmental rating by the BRE.

- Zero ODP- no blowing agents
- GWP- Less than 5

This demonstrates our passion for making a difference not just in the present, but for our future.



T: 01582 450814

E: info@thermal-economics.co.uk

W: www.thermal-economics.co.uk



Visit our website for mobile friendly installation guides



Choose the right product- call Thermal Economics Technical Department on 01582 544255
 For all our Acoustic and Thermal insulation products visit: www.thermal-economics.co.uk