

Specification for the Installation of FLOORTHERM MP over the Battens of a Timber Raft on a Concrete Ground Floor

- 1) Timber battens of minimum depth 50mm should be fixed to the concrete floor at centres to suit the thickness of the flooring boards. **N.B.** If the concrete floor is not level or has a camber due to prestressing the battens can be supported where required on TE galvanised steel levelling channels incorporating packers supplied.

ALTERNATIVE METHODS OF INSTALLING FLOORTHERM OVER BATTENS:

A) PARALLEL TO BATTENS (see fig. 1)

- 2) A width of Floortherm MP (990mm to suit battens at 400mm centres) should be rolled out along the battens as shown in fig.1 from wall to wall and cut to size to include an upstand at each end of minimum 70mm (see fig.3).

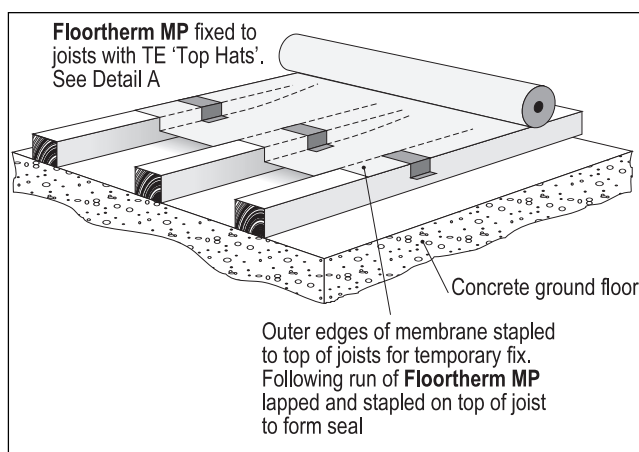
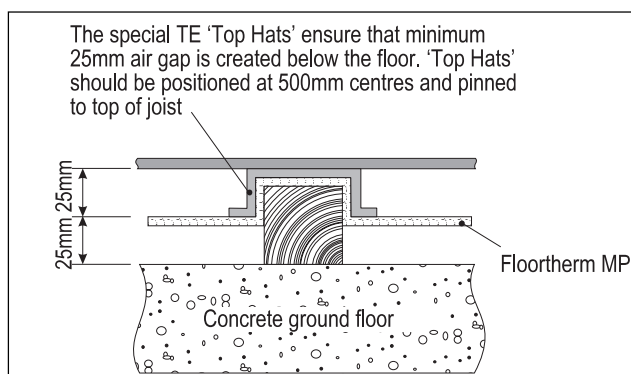

Fig. 1

- 3) The long side of this roll width should also be dressed a minimum 70mm up the gable wall (see fig. 3).

- 4) The material is positioned along the battens with the edges against the corner of the outside battens as shown in fig. 1 and temporarily fixed with staples or clout nails. The 'Top Hat' channels are then pushed over the material onto the battens at 500mm maximum centres as shown to create a 25mm air gap above and below the Floortherm (see detail A).



Detail A

- 5) Subsequent widths of Floortherm MP are installed as given above to cover the area of the ground floor with the 50mm lap between each width being positioned and held on the top of the batten by the 'Top Hat' channels (see detail A).
- 6) The last width should be installed along the battens as given with a minimum 70mm upstand to the end wall along the long edge of the material (i.e. similar to fig. 3).
- 7) The flooring should be installed by fixing through the Floortherm onto the battens taking care that the material is left protruding above the floor to be eventually held behind the skirting board as shown in fig. 3.

B ACROSS BATTENS (see fig. 2)

- 8) A first roll of Floortherm MP should be rolled out over the battens from wall to wall and cut to size to include an upstand at each end of minimum 70mm (see fig. 3).
- 9) The long side of this roll width should also be dressed a minimum 70mm up the gable wall (see fig. 3).

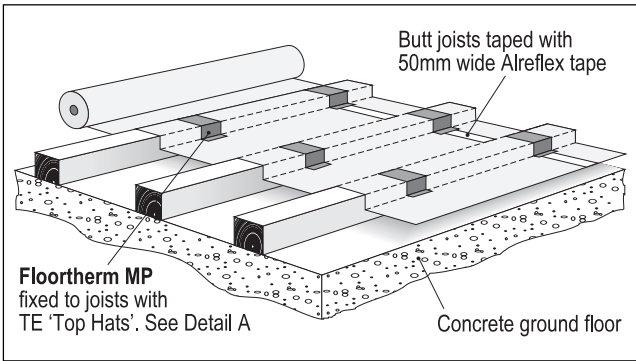

Fig. 2

- 10) As shown in Detail 'A' Floortherm MP is installed over the battens, fixed with the special TE 'Top Hat' channels and pulled tight to create 25mm air gaps above and below the material (see detail A). The 'Top Hat' channels should be fitted at 500mm centres maximum (see fig. 2).

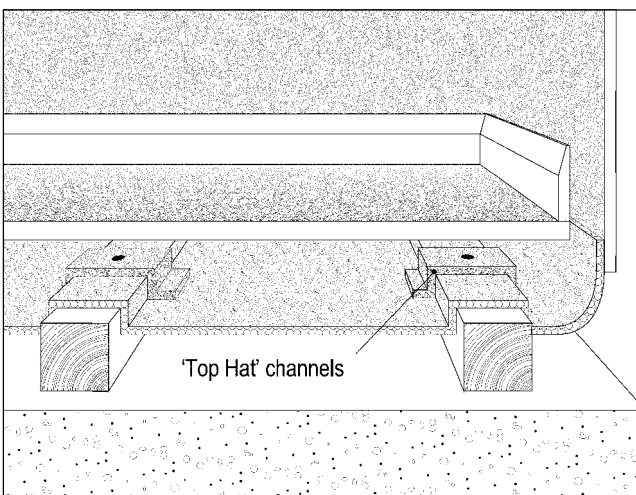

Fig. 3

- 11) Subsequent widths of Floortherm MP should be laid over the battens as given in paragraph 8, butted against the previous width and fixed to the battens with the 'Top Hats' as given in paragraph 10 and shown in fig. 2. All butt joints should be sealed with 50mm wide Alreflex s/a aluminium tape.

- 12) The last width should be installed over the joists using the 'Top Hats' and be dressed a minimum 70mm up the end wall (see fig. 3).

- 13) The flooring should be fixed through the Floortherm to the battens taking care that the Floortherm is protruding all around to be eventually held behind the skirting (see fig. 3).

If after reading the above you still have queries regarding the installation of Floortherm MP please contact The Technical Department of Thermal Economics Ltd. on tel. 01582 450814 or fax. 01582 429305 **before installing the material**